

# Durawall

High-impact wall protection can be installed over a variety of substrates.  
Durawall is high-resolution digitally printed with custom imagery.



## Technical

- Reverse Printed Polycarbonate Sheet
- Adhesive mounted to existing smooth wall surfaces.
- 48" Standard Panel Widths
- 60" Widths Available upon request to reduce seams.
- Vertical heights seamless, up to 25' or more.

## Features

- Tested in accordance with ASTM E381 Class A/1 Fire characteristics for .020" thicknesses.
- Velvet, scratch-resistant surface texture
- 1-year product warranty standard 5+ years available
- Extreme durability: Able to be cleaned with traditional sanitizing products without affecting the graphic
- .020" thickness is UL V-O rated flame retardant film

## Options

- Custom designs available upon request
- Install on radius walls possible, with custom forming and cut-to-size available
- Color matched & clear silicone caulk used at seams
- Aluminum edge trim guards available in 12' (3.7m) lengths
- Durawall is available in standard thicknesses of .020", .030", .040" thickness
- Additional thickness up to .060" available when requested as a custom order



# Opaque Graphic Film Color card Reference Guide

Custom Images | Custom Colors | Custom Patterns

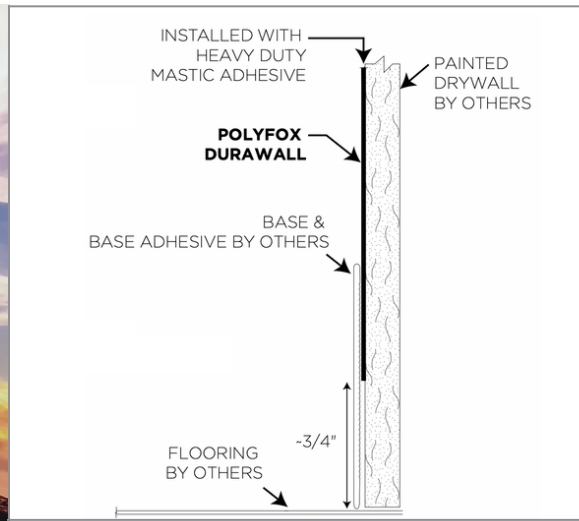

## THERMAL

Coefficient of Thermal Conductivity	ASTM D5470	Btu/hr/ft <sup>2</sup> /°F/in	1.35		W/m <sup>2</sup> K	0.2
Coefficient of Thermal Expansion	ASTM E831	(x10 <sup>-5</sup> /°F)	3.2	ISO 11359	(x10 <sup>-5</sup> /°C)	5.8
Specific Heat @40°F (4°C)	ASTM E1269	Btu/lb/°F	0.3		KJ/Kg°C	1.25
Glass Transition Temperature	ASTM D3417 / D3418	°F	307	ISO 11357	°C	153
Vicat Softening Temperature, B	ASTM 1525-00 modified	°F	347			
Heat Deflection Temp. by TMA at 1.8 Mpa		°F	290	ISO 75 Modified	°C	145
Shrinkage at 302°F(150°C)	ASTM D1204	%	0.02		%	0.02